

EXAMPLE OF RENDERING FOR MONUMENT SIGNS AND GENERAL REQUIREMENTS

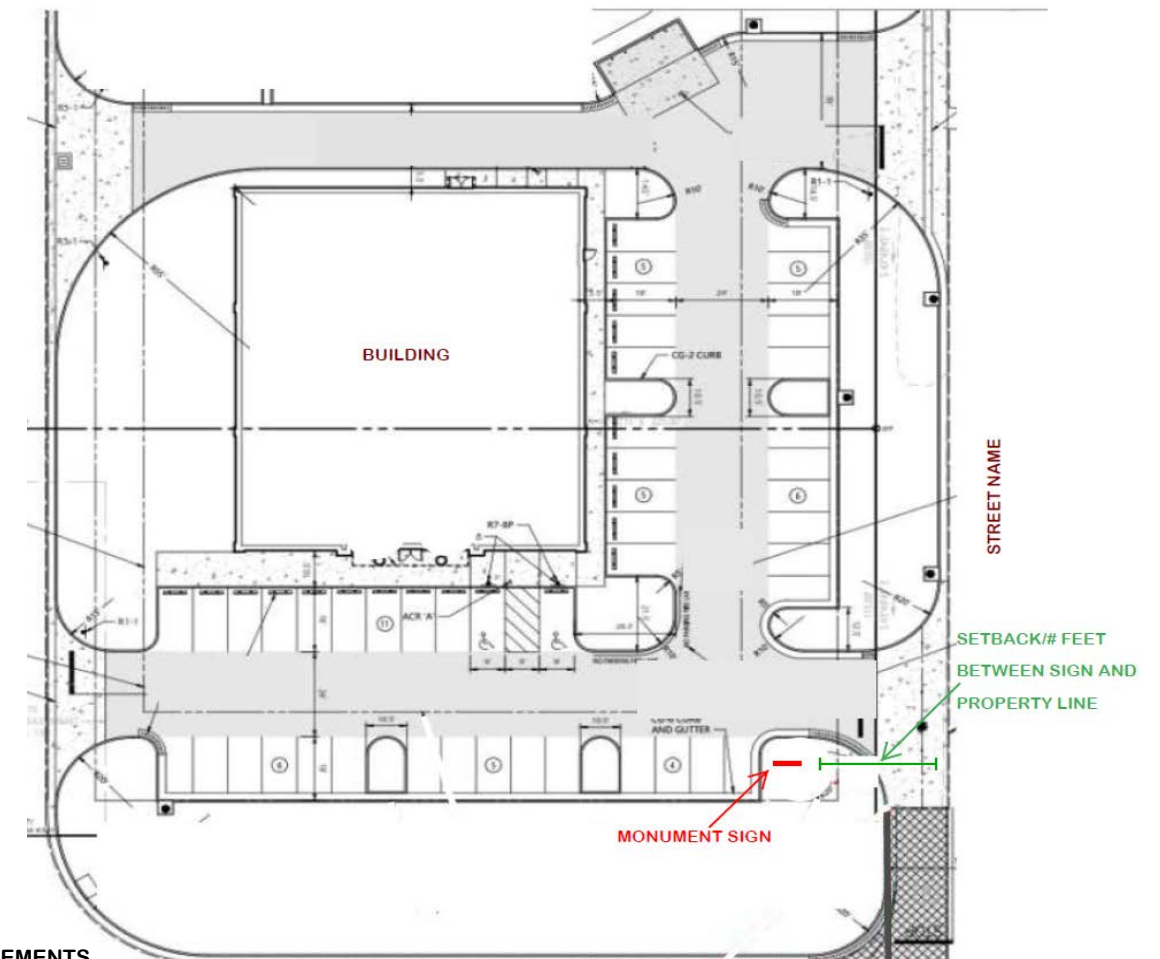

- ✓ SHOW EXACT SIZE, LENGTH, HEIGHT AND AREA
- ✓ IF THE SIGN FACE DOES NOT SIT DIRECTLY ON THE BASE OR GROUND, SHOW THE MEASUREMENT FOR THE SEPARATING SPACE
- ✓ INDICATE TYPE OF LIGHTING/ILLUMINATION (INTERNAL, EXTERNAL, NON-ILLUMINATED)
- ✓ SHOW PROPOSED LOCATION OF SIGN ON A SITE PLAN
- ✓ SITE PLAN SHOWS THE SETBACK/HOW MANY FEET THE SIGN IS PROPOSED TO BE FROM THE PROPERTY LINE
- ✓ SIGNS OVER 6 FEET IN HEIGHT MUST HAVE A STAMPED ENGINEERED FOOTING PLAN



Freestanding Signs - 1 Sign Permitted Per Frontage			
Lot Size	Setback	Max Sign Area	Max Height
2 acres or less	15 feet from the street right of way	64 square feet	12 feet
Above 2 acres but less than 5	35 feet from the right of way	96 square feet	12 feet
5 acres or more	50 feet from the right of way	125 square feet	16 feet

The sign either has no space between the sign face and the ground or is supported by a base, the width of which is at least two-thirds ($\frac{2}{3}$) the width of the sign face.

If the sign face is supported by a base, the sign face sits directly on the base or is separated from the base by a space of not more than eighteen (18) inches.

Message Boards	
Message boards may be erected as part of a permitted freestanding or wall sign, subject to the following requirements:	
a. The sign area of the message board may cover up to a maximum of fifty (50) percent of the total sign area authorized for the sign of which the message board is a part.	
b. Except as otherwise provided for electronic message boards, the individual letters or numbers of the message board sign copy shall be made of durable plastic, metal or other similar material and shall be firmly secured to the sign face.	

* PLEASE NOTE THE INFORMATION PROVIDED HEREIN IS NOT ALL INCLUSIVE, PLEASE REFER TO ARTICLE 14-700 OF THE CHESAPEAKE ZONING ORDINANCE FOR FULL REQUIREMENTS