

■ INDICATES CHANNEL WHERE WIRE MESH REINFORCEMENT IS NOT REQUIRED.

SY/LF OF PAVED CHANNEL

CONCRETE THICKNESS	D	W									
		1'	2'	3'	4'	5'	6'	7'	8'	9'	10'
1:1 SIDE SLOPES											
4"	1'	0.425 <sup>■</sup>	0.536	0.648	0.759	0.870	0.981	1.092	1.203	1.314	1.425
	2'	0.740 <sup>■</sup>	0.851	0.962	1.073	1.184	1.295	1.406	1.517	1.629	1.740
	3'	1.054 <sup>■</sup>	1.165	1.276	1.387	1.498	1.609	1.721	1.832	1.943	2.054
	4'	1.368	1.479	1.590	1.702	1.813	1.924	2.035	2.146	2.257	2.368
6"	5'	1.682	1.794	1.905	2.016	2.127	2.238	2.349	2.460	2.571	2.682
	6'	1.997	2.108	2.219	2.330	2.441	2.552	2.663	2.774	2.886	2.997
	7'	2.311	2.422	2.533	2.644	2.755	2.866	2.977	3.089	3.200	3.311
	8'	2.625	2.736	2.848	2.959	3.070	3.181	3.292	3.403	3.514	3.625
	9'	2.940	3.051	3.162	3.273	3.384	3.495	3.606	3.717	3.828	3.939
	10'	3.254	3.365	3.476	3.587	3.698	3.809	3.920	4.032	4.143	4.254
1 1/2 : 1 SIDE SLOPES											
4"	1'	0.512 <sup>■</sup>	0.623	0.734	0.845	0.956	1.067	1.178	1.290	1.401	1.512
	2'	0.912 <sup>■</sup>	1.023	1.135	1.246	1.357	1.468	1.579	1.690	1.801	1.912
	3'	1.313 <sup>■</sup>	1.424	1.535	1.646	1.757	1.869	1.980	2.091	2.202	2.313
	4'	1.714	1.825	1.936	2.047	2.158	2.269	2.380	2.491	2.602	2.714
6"	5'	2.114	2.225	2.336	2.448	2.559	2.670	2.781	2.892	3.003	3.114
	6'	2.515	2.626	2.737	2.848	2.959	3.070	3.181	3.293	3.404	3.515
	7'	2.915	3.027	3.138	3.249	3.360	3.471	3.582	3.693	3.804	3.915
	8'	3.316	3.427	3.538	3.649	3.760	3.872	3.983	4.094	4.205	4.316
	9'	3.717	3.828	3.939	4.050	4.161	4.272	4.383	4.494	4.606	4.717
	10'	4.117	4.228	4.340	4.451	4.562	4.673	4.784	4.895	5.006	5.117
2:1 SIDE SLOPES											
4"	1'	0.608 <sup>■</sup>	0.719	0.830	0.941	1.052	1.164	1.275	1.386	1.497	1.608
	2'	1.105 <sup>■</sup>	1.216	1.327	1.438	1.549	1.660	1.772	1.883	1.994	2.105
	3'	1.602 <sup>■</sup>	1.713	1.824	1.935	2.046	2.157	2.268	2.380	2.491	2.602
	4'	2.099	2.210	2.321	2.432	2.543	2.654	2.765	2.876	2.988	3.099
6"	5'	2.596	2.707	2.818	2.929	3.040	3.151	3.262	3.373	3.485	3.596
	6'	3.093	3.204	3.315	3.426	3.537	3.648	3.759	3.870	3.981	4.093
	7'	3.589	3.701	3.812	3.923	4.034	4.145	4.256	4.367	4.478	4.589
	8'	4.086	4.197	4.309	4.420	4.531	4.642	4.753	4.864	4.975	5.086
	9'	4.583	4.694	4.805	4.917	5.028	5.139	5.250	5.361	5.472	5.583
	10'	5.080	5.191	5.302	5.413	5.525	5.636	5.747	5.858	5.969	6.080

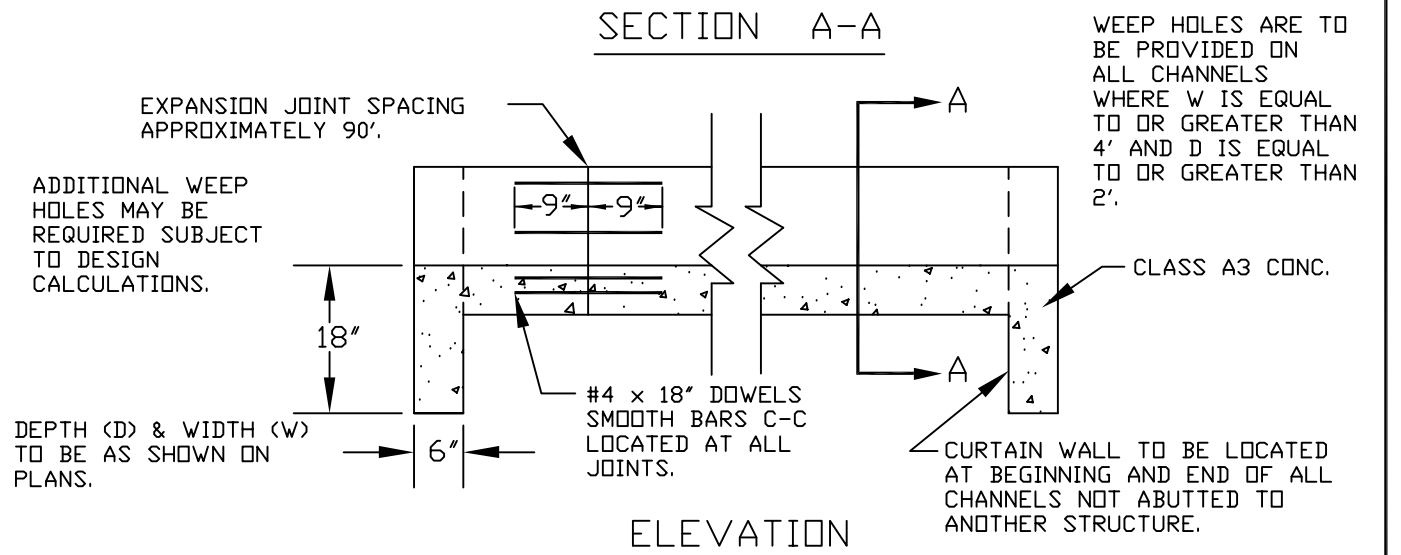
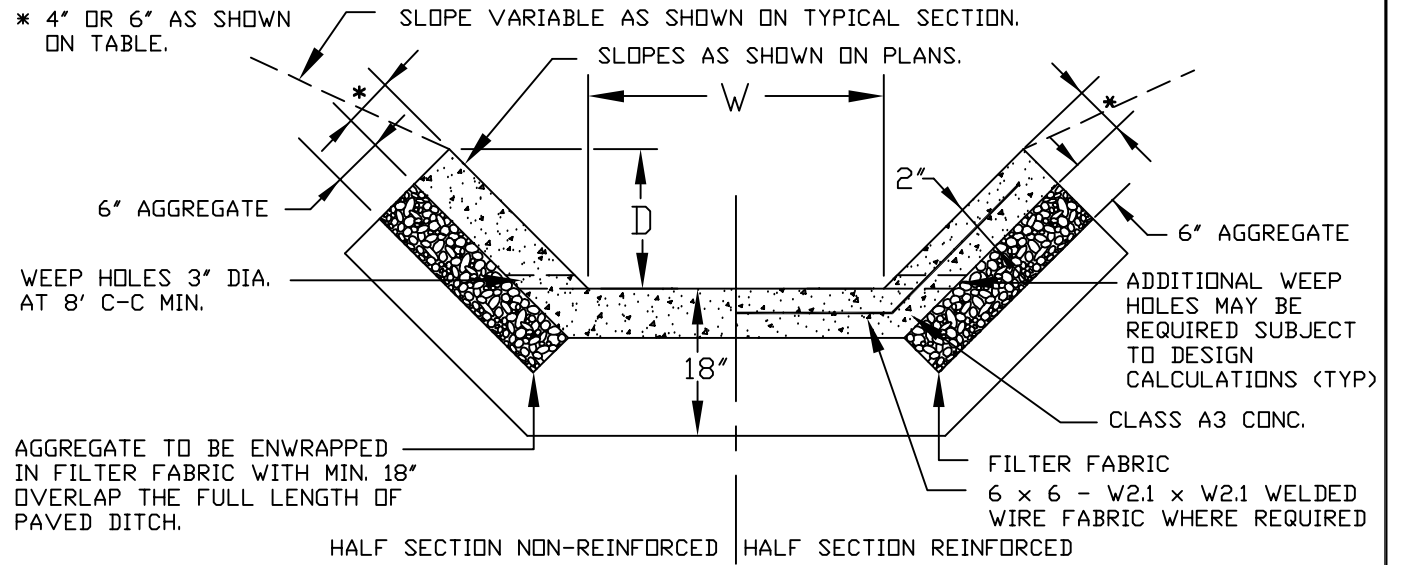

		DESIGN AND CONSTRUCTION STANDARDS	
		<h1>PAVED DITCH</h1>	
08/01/03	REV. FOR INTERNET 2003	DR. BY:	DATE:
DATE		CHK. BY:	DATE:
		APP. BY:	DATE:

**PD-1**

APPROVED FOR THE WEB \_\_\_\_\_  
 City Engineer \_\_\_\_\_ Date \_\_\_\_\_

FILE G:\...ACADFILES\PFM\DRAINAGE\32\ PD-1