

SITE PLAN OF ETHERIDGE GREENS

GOLF COURSE

EROSION AND SEDIMENTATION CONTROL PLAN BUTTS ROAD BOROUGH - CHESAPEAKE, VIRGINIA

T.P. 0620000000020

DECEMBER, 2002

PLAN REVISION
APPROVED FOR CONSTRUCTION

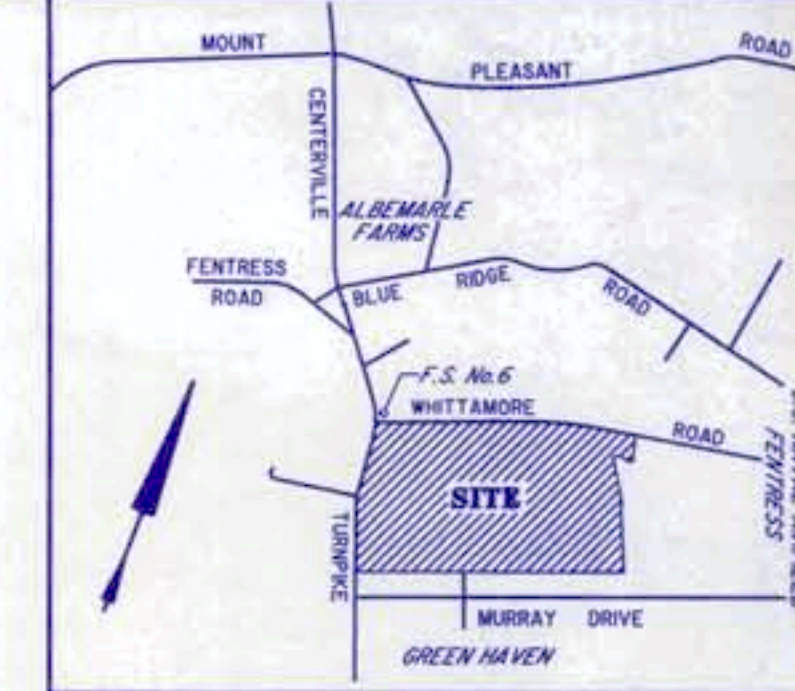

LOCATION MAP 1"=2000'

BENCHMARK DATA

BASED ON CITY OF CHESAPEAKE T.B.M.
GPS # 051. ELEVATION 15.35
LOCATED ON WHITTAMORE ROAD
IN FRONT OF FIRE STATION

VERTICAL CONTROL IS ON THE
STATE 1959 ELEVATION ADJUSTMENT
OF THE NGVD 1929 DATUM RELATIVE
TO THE SOURCE BENCHMARK

APPROVED FOR CONSTRUCTION
CHESAPEAKE PUBLIC WORKS DEPARTMENT
ENGINEERING DIVISION

YES	NO	N/A	
Yes	No	N/A	EROSION AND SEDIMENT CONTROL
Yes	No	N/A	ENTRANCE AND SITE IMPROVEMENTS
Yes	No	N/A	STORMWATER QUALITY (BMP)
Yes	No	N/A	STREET IMPROVEMENTS
Yes	No	N/A	DRAINAGE IMPROVEMENTS
Yes	No	N/A	PUBLIC UTILITIES IMPROVEMENTS
Yes	No	N/A	SOIL DRAINAGE MANAGEMENT PLAN (SDMP)
Yes	No	N/A	LANDSCAPE PLAN

REFER TO APPROVAL LETTER DATE 12/23/02

SCHEDULE OF DRAWINGS:

COVER SHEET	1
PLANSHEETS	2 - 3
NOTES AND DETAILS	4

ENGINEER'S ESTIMATE OF REQUIRED PUBLIC IMPROVEMENTS

ITEM DESCRIPTION	NUMBER OF UNITS	UNIT PRICE	TOTAL
LAND DISTURBING (EROSION AND SEDIMENT CONTROL)			
DISTURBED ACREAGE	190 AC.	\$500.00/AC	\$95,000.00
SILT FENCE	13,500 L.F.	\$5.00 L.F.	\$67,500.00
CONSTRUCTION ENTRANCE	1 EA.	\$3000.00 EA.	\$3,000.00
4' BOTTOM DITCH	6,150 C.Y.	7.00 C.Y.	\$43,050.00
ROCK CHECK DAM	5 EA.	\$400.00 EA.	\$2,000.00
SUBTOTAL			\$210,050.00
CONTINGENCY (10% OF TOTAL)			\$21,005.00
TOTAL			\$231,055.00

THE ABOVE ESTIMATE REPRESENTS ALL PUBLIC IMPROVEMENTS CONTAINED IN PUBLIC RIGHTS-OF-WAY OR PUBLIC EASEMENTS INCLUDING RESTORATION. UNIT PRICES BASED ON CITY SITE BOND UNIT PRICE LIST DATED 07-01-95. FIGURE REPRESENTS THE MINIMUM SURETY REQUIRED FOR THE ISSUANCE OF DEPARTMENT OF PUBLIC WORKS PERMITS. BOND FIGURE VALID FOR CONSTRUCTION TO BE COMPLETED IN 12 MONTHS OF PLAN APPROVAL.

CITY PERMITS REQUIRED FOR SITE DEVELOPMENT

- LAND DISTURBING
- ENTRANCE / RIGHT-OF-WAY
- CHESAPEAKE BAY PRESERVATION / STORMWATER
- EXCAVATION PERMITS

NOTES:

- CONSTRUCT A LEFT TURN LANE ON CENTERVILLE TURNPIKE AT WHITTAMORE ROAD PRIOR TO INITIAL DELIVERY OF FLY ASH TO THE SITE PER UP-01-03.
- WIDEN WHITTAMORE ROAD TO 24' OF PAVEMENT FROM THE PROJECT ENTRANCE TO THE INTERSECTION OF CENTERVILLE TURNPIKE PRIOR TO INITIAL DELIVERY OF FLY ASH TO THE SITE PER UP-01-03.

STORM WATER UTILITY

BUILDING AREA:	0 SQ. FT.
PAVEMENT AREA	0 SQ. FT.
OTHER IMPERVIOUS AREA	0 SQ. FT.

NOTE: THESE PLANS HAVE BEEN PREPARED IN ACCORDANCE WITH THE APPLICABLE SECTIONS OF THE CHESAPEAKE CITY CODE AND ALL VOLUMES OF THE CHESAPEAKE "PUBLIC FACILITIES MANUAL".

SIGNED: *[Signature]* P.E.

BMP INFORMATION

OWNERSHIP OF BMP'S	PRIVATE
TYPE OF BMP	WET POND
(WET DETENTION)	
STORAGE CAPACITY	
BMP No. 1	80.8 AC./FT.
BMP No. 2	3.8 AC./FT.
BMP No. 3	9.9 AC./FT.
BMP No. 4	6.7 AC./FT.
BMP No. 5	5.7 AC./FT.
BMP No. 6	4.9 AC./FT.
TOTAL	111.8 AC./FT.
DRAINAGE WATERSHED	POCATY RIVER

APPROVED PLAN

DATE: MAY 8, 2002



CONSTRUCTION PLAN ASSIGNMENT

RE: ETHERIDGE GREENS GOLF COURSE - EROSION CONTROL PLAN

THE UNDERSIGNED ENGINEER/FIRM AGREES THAT THE CITY OF CHESAPEAKE SHALL HAVE THE RIGHT TO USE THESE PLANS TO COMPLETE THE PERMANENT PHYSICAL IMPROVEMENTS IN THE EVENT THAT THE DEVELOPER DEFAULTS IN HIS OBLIGATIONS TO COMPLETE THESE FACILITIES AS REQUIRED BY CITY CODE. THE UNDERSIGNED ENGINEER ALSO AGREES THAT THE CITY MAY USE THESE PLANS FOR THE PREPARATION OF "AS-BUILT" RECORDS AS NECESSARY. THE ENGINEER/FIRM FURTHER AGREES THAT THESE RIGHTS TO USE THE PLANS SHALL BE PROVIDED WITHOUT COST TO THE CITY.

NAME: WYMER W. MANNING, III TITLE: PROJECT MANAGER

FIRM: HASSELL & FOLKES, P.C.

SIGNATURE: *[Signature]* DATE: 12/23/02

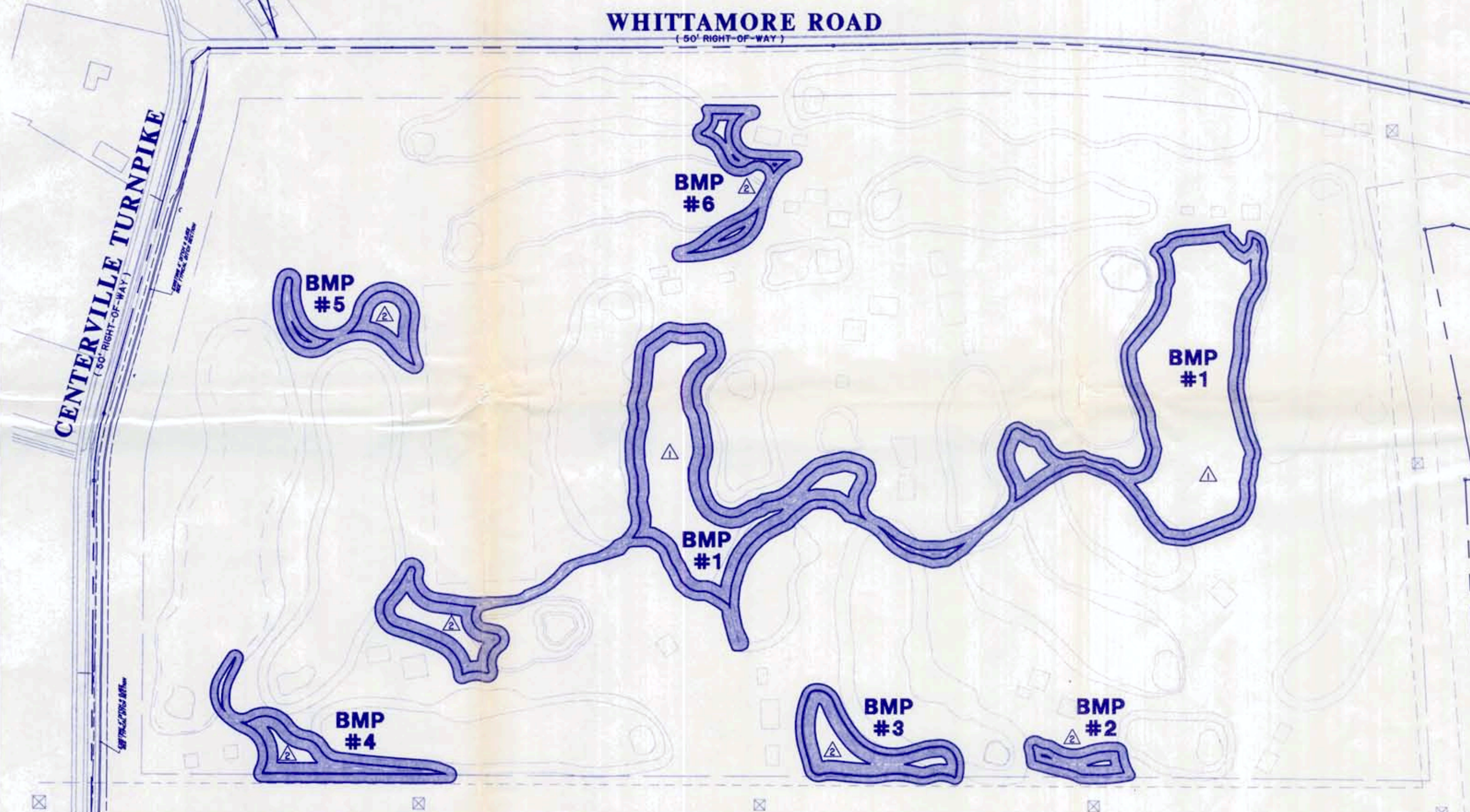
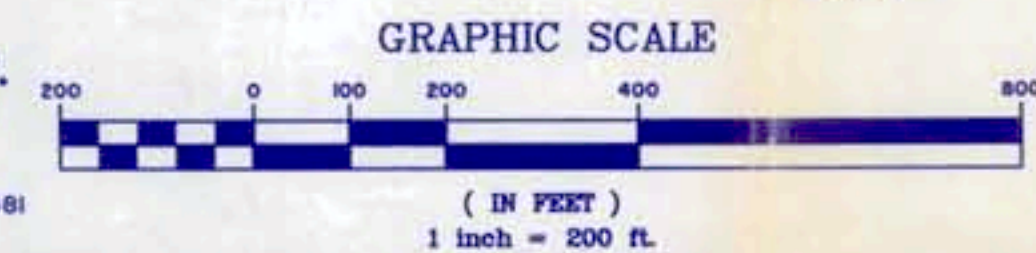

NOTE

THE CONTRACTOR SHALL PROVIDE WRITTEN NOTIFICATION TO ALL OWNERS AND RESIDENTS OF PROPERTY ADJACENT TO THIS DEVELOPMENT AND OFFSITE IMPROVEMENTS 30 DAYS PRIOR TO THE COMMENCEMENT OF WORK UNLESS OTHERWISE DIRECTED BY THE CITY. CONSTRUCTION WITHIN EASEMENTS OR ON PUBLIC RIGHT-OF-WAY NECESSITATES NOTICE WHETHER ADJACENT TO OR LOCATED ON THE ADJOINING PROPERTY. FAILURE TO PROVIDE THE MINIMUM NOTIFICATION TIME WILL RESULT IN A SUSPENSION OF WORK.

SITE DATA

PROPERTY ZONED: A-1
SITE AREA: 216.91 Ac.
DISTURBED AREA: 190 Ac.
R/W DEDICATION 0 ACRES

USE PERMIT No. UP-01-03

PROPOSED USE
GOLF COURSE - DRIVING RANGE

OWNER

COMBUSTION PRODUCTS MANAGEMENT, INC.
1229 KINGSBURY DRIVE
CHESAPEAKE, VIRGINIA 23322
PHONE/FAX (757) 546-2462

HASSELL & FOLKES, P.C.
ENGINEERS-SURVEYORS-PLANNERS
325 VOLVO PARKWAY
CHESAPEAKE, VIRGINIA 23320
PHONE: (757) 547-9531 FAX: (757) 547-9481

NOTIFY
Miss Utilities At
1-800-552-7001
For Location of Existing Utilities

MARK	REVISION	DATE	APPROVED
△	REVISED RELOCATED DITCH - ADDED WATER FEATURES	DEC., 2002	
△	ADDED PROPOSED GOLF COURSE LAKE	APR. 2002	1881

AUTOCAD FILE NAME: EANDS-CORRECTED.DWG DRAWER No.: APPROVAL DATE: